



FUEL INJECTION PERFORMANCE KIT
FIPK

GENERATION II™

INSTALLATION INSTRUCTIONS

57-3020

Chevrolet
1997-00 Corvette
V8-5.7L

NOTE:

Due to close tolerances,
the intake tube may rub the
underhood installation.

TOOLS NEEDED:

Flat Blade Screwdriver	File
3/8" Wrench	Jig Saw
7mm Wrench	Utility Knife
10mm Wrench	Drill
1/8" Allen Wrench	3/16" Drill Bit
Ratchet	5/16" Drill Bit
Socket Extension	3/4" Drill Bit
10mm Socket	

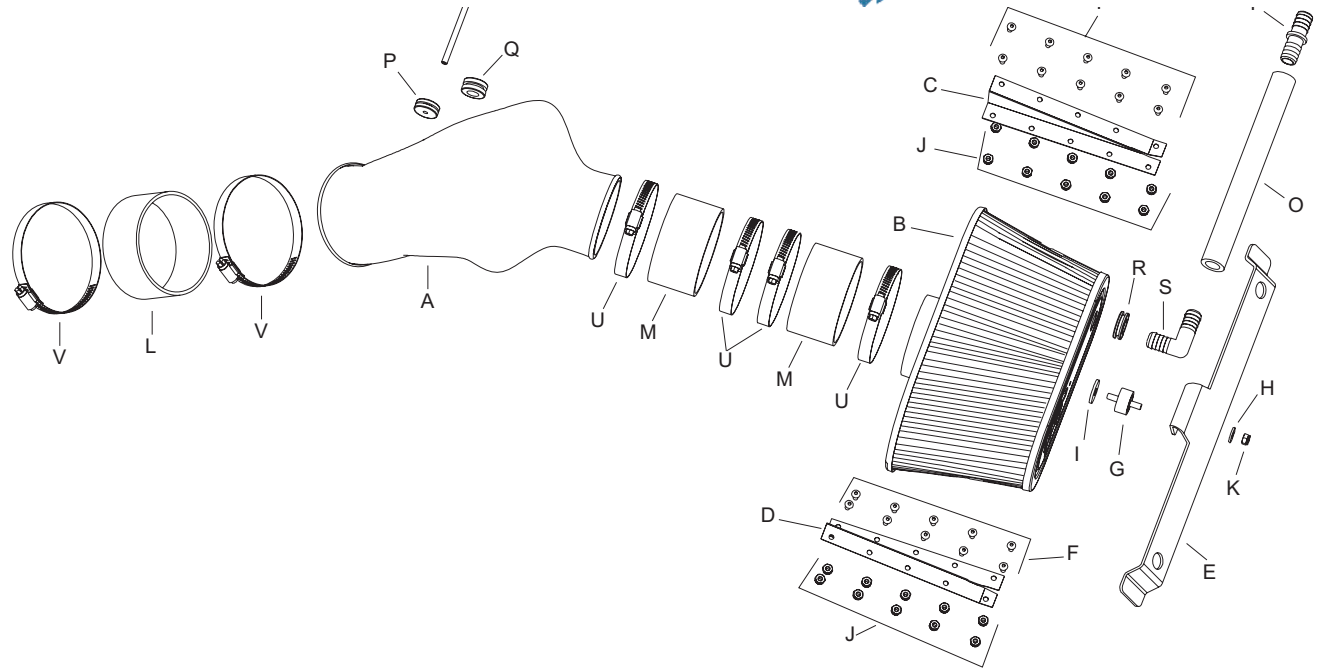

PARTS LIST:

Desc.	Qty.	Part #	Desc.	Qty.	Part #	Desc.	Qty.	Part #	Desc.	Qty.	Part #
A Intake tube	1	08754	G Rubber Mntd stud	1	07027	M 3.5" ID silicone hose	2	08630	S 90 deg. vent	1	08072
B Air filter element	1	RF-1038	H Flat washer	1	08275	N 1/8" ID vent hose	1	08106	T Hose mender	1	08048
C Rt. angled "Z" bracket	1	070832	I Rubber washer	1	21685	O 5/8" ID vent hose	1	08691	U Hose clamp #56	4	08620
D Lt. angled "Z" bracket	1	070842	J 10-32 nylock jam nut	20	08253	P 3/16" ID grommet	1	08054	V Hose clamp #64	2	08648
E Angled bracket1	1	07137	K 6mm nylock nut	1	07553	Q 1/2" ID grommet	1	08064			
F BTN. Head bolt	20	08387	L 4" ID silicone hose	1	08761	R 5/8" ID grommet	1	08053			

NOTE: FAILURE TO FOLLOW INSTALLATION INSTRUCTIONS AND NOT USING THE PROVIDED HARDWARE MAY DAMAGE THE INTAKE TUBE, THROTTLE BODY, AND ENGINE.

TO START:

1. Turn the ignition OFF and disconnect the vehicle's negative battery cable.

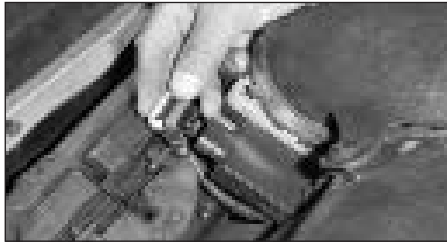

2. Disconnect the mass air sensor electrical connection.

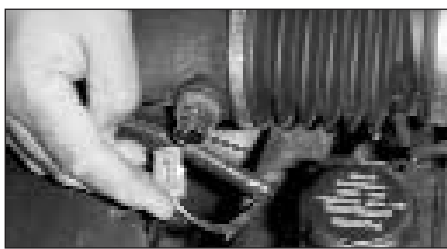

3. Disconnect the air temperature sensor electrical connection.

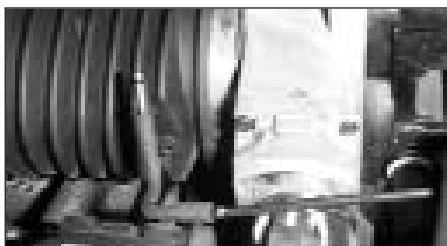

4. On models equipped with a fuel pressure regulator vacuum line, disconnect the vent from the intake hose.



5. On models equipped with a fuel pressure regulator vacuum line, disconnect the vent hose from the fuel pressure regulator vacuum tube.

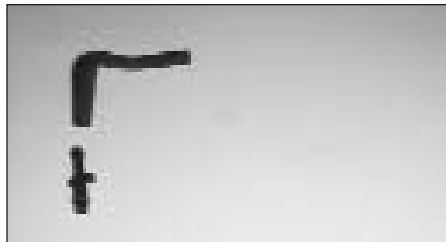

6. On models equipped with a fuel pressure regulator vacuum line, detach the vent from the vent hose.



7. Disconnect the air injection vent hose.



8. Release the push clips that retain the stock intake tube to the upper radiator cover.



9. Loosen the hose clamp on the intake hose at the throttle body.



10. Pull the airbox towards the engine to release it from its mounting grommets.



11. Detach the intake hose from the throttle body and remove the entire air intake assembly. **NOTE: K&N recommends that customers do not discard factory air intake.**



12. Detach the wiring harness retaining clip from the lower radiator cover.



13. Loosen the hose clamp and detach the stock intake tube from the mass air sensor.



14. Remove the air temperature sensor from the stock intake tube.



15. Remove the mass air sensor retaining clamp.



16. Remove the mass air sensor from the airbox.



17. Remove the two grommets from the airbox mounting points.

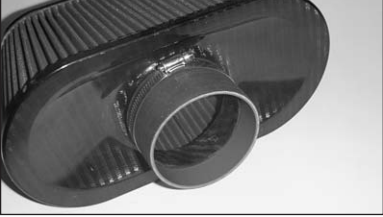

18. Attach the 3.5" ID silicone hose (08630) onto the flange of the Air filter element.



19. Install the mass air sensor into the silicone hose with the arrow on the mass air sensor pointing away from the Air filter element.



20. Install the 5/8" ID grommet and the rubber mounted stud into the top plate of the Air filter element.



21. Insert the 1/2" ID grommet into the hole in the K&N intake tube.



22. On models equipped with a fuel pressure regulator vacuum line, drill out the drill point in the K&N intake tube using a 3/4" drill bit.



23. On models equipped with a fuel pressure regulator vacuum line, insert the 3/16" ID grommet into the hole drilled in the previous step.



24. Insert the air temperature sensor into the 1/2" ID grommet.



25. Assemble the 90 degree vent, hose mender and vent hose provided as shown.

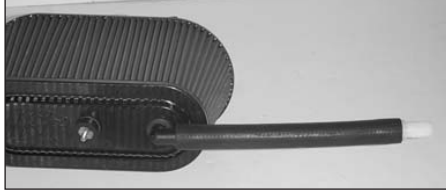

26. Insert the 90 degree vent into the grommet in the top plate of the filter.



27. Install the 4" ID silicone hose onto the K&N intake tube.



28. Install a 3.5" ID silicone hose (08630) onto the K&N intake tube.



29. Attach the angled bracket to the rubber mounted stud using the provided hardware. **Note: Do not tighten completely at this time.**

30. Install the grommets removed in step 17 into the holes in the angled bracket.

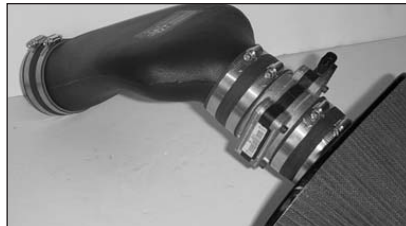

31. Assemble the intake tube and Air filter element assemblies.



32. Install the K&N intake assembly.

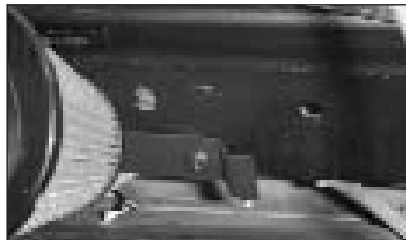

33. Install the angled bracket onto the original airbox mounting points.

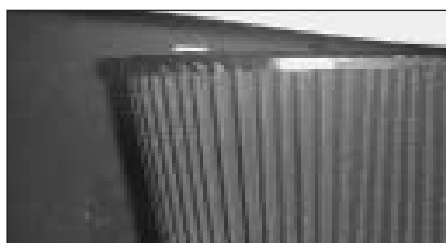

34. Using the top of the Air filter element as a guide, mark the lower radiator cover a minimum of 1/2" above the filter.

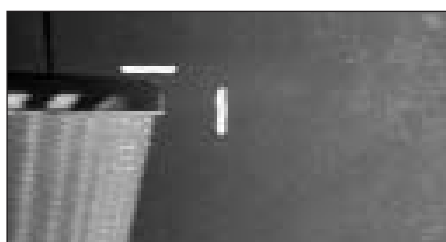

35. Using the Air filter element as a guide, mark a minimum of 1/2" away from the Air filter Element.

36. Release the angled bracket from it's mounting points and remove the K&N intake assembly.



37. Loosen and remove the four bolts that retain the upper radiator cover.



38. Remove the upper radiator cover.



39. Loosen and remove the five bolts that mount the lower radiator cover to the bumper cover on the underside of the car.



40. Loosen and remove the two bolts that retain the lower radiator cover to it's mounting brackets.



41. Detach the courtesy lamp wiring harness from the lower radiator cover.



42. Pull firmly to release the radiator cover from it's retaining clips.



43. Remove the lower radiator cover.



44. Using the indicated horizontal and vertical marks, connect the upper and side trim lines as shown.

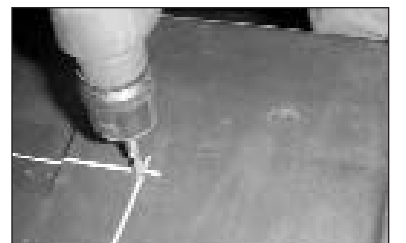

45. Using a 5/16" drill bit, drill a hole where the horizontal and vertical lines intersect.



46. Using a jigsaw, cut along the horizontal and vertical lines.

Note: It will be necessary to clean up the cuts with a file.

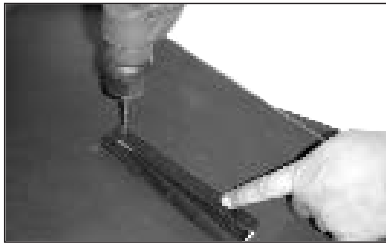

47. Hold the right angled "Z" bracket in place, using a 3/16" drill bit, drill out the five outer holes.



48. Secure the bracket to the lower radiator cover with the hardware provided.

49. Repeat the two previous steps with the left angled "Z" bracket.

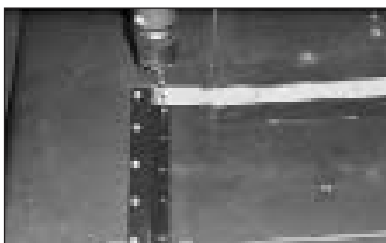

50. Drill out the five inner holes of each bracket.



51. Secure the flap to the brackets with the hardware provided.



52. Reinstall the lower radiator cover.

53. Reattach the courtesy lamp wiring harness to the lower radiator cover.

54. Secure the lower radiator cover to the bumper cover and mounting brackets using the bolts removed in steps 39 and 40.

55. Reinstall the upper radiator cover and secure with the original retaining bolts. Do not tighten completely.



56. Reinstall the K&N intake assembly then adjust the radiator cover for best fit under the intake tube, then tighten the 4 retaining bolts.



57. Install the angled bracket onto the original airbox mounting points.



58. Cut the air injection vent hose as shown.



59. Attach the air injection hose to the hose mender.

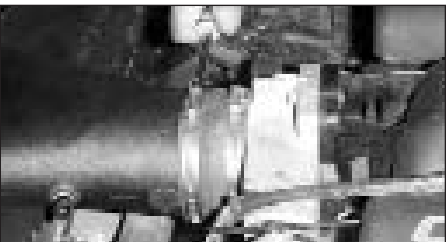

60. Attach the silicone hose to the throttle body and tighten the hose clamps.



61. On models equipped with a fuel pressure regulator vacuum line, insert the OE vent into the 1/8" ID vent hose provided.

Note: The larger diameter end should be exposed.



62. On models equipped with a fuel pressure regulator vacuum line, attach the 1/8" ID vent hose to the vacuum tube and insert the hose mender into the grommet.



63. Reconnect the mass air sensor electrical connection.



64. Reconnect the air temperature sensor electrical connection.

65. Reattach the wiring harness retaining clip to the lower radiator cover.

66. Reconnect the vehicle's negative battery cable. Double check to make sure everything is tight and properly positioned before starting the vehicle.

67. The C.A.R.B. exemption sticker, (attached), must be visible under the hood, so an emissions inspector can see it when the vehicle is required to be tested for emissions. California requires testing every two years other states may vary.

68. It will be necessary for all FIPK's to be checked periodically for realignment, clearance and tightening of all connections. Failure to follow the above instructions or proper maintenance may void warranty.

ROAD TESTING:

1. Start the engine with the transmission in neutral or park, and the parking brake engaged. Listen for air leaks or odd noises. For air leaks secure hoses and connections. For odd noises, find cause and repair before proceeding. This kit will function identically to the factory system except for being louder and much more responsive.

2. Test drive the vehicle. Listen for odd noises or rattles and fix as necessary.

3. If road test is fine, you can now enjoy the added power and performance from your kit.

4. K&N suggests checking the Air filter element periodically for excessive dirt build-up. When the element becomes covered in dirt (or once a year), service it according to the instructions on the Recharger service kit, part number 99-5050 or 99-5000.